

DivL 1700

BASELINE

BASELINE

0 1 2 3 4 5 6 7 8 9 10 11 12 13 14 15 16 17 18 19 20 21 22 23 24 25 26 27 28 29 30 31 32 33 34 35 36 37

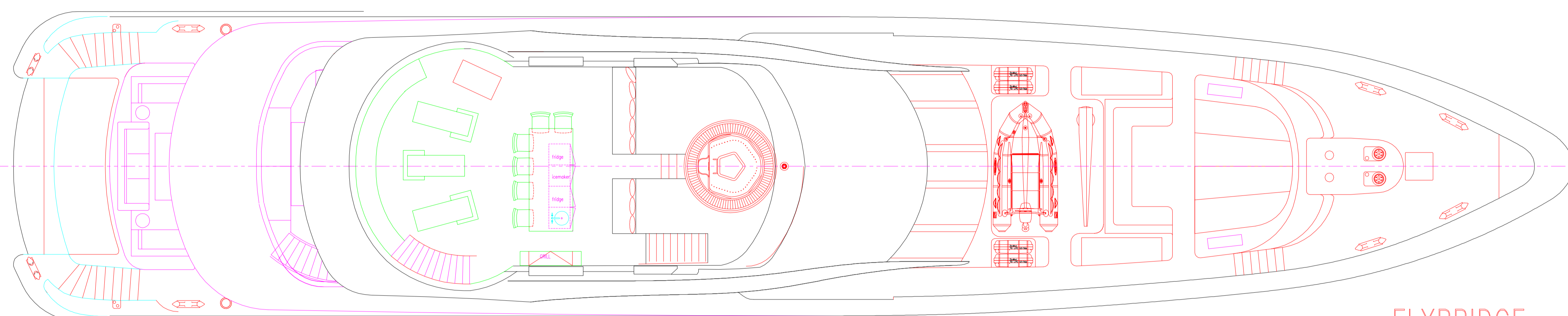

FLYBRIDGE

0 1 2 3 4 5 6 7 8 9 10 11 12 13 14 15 16 17 18 19 20 21 22 23 24 25 26 27 28 29 30 31 32 33 34 35 36 37

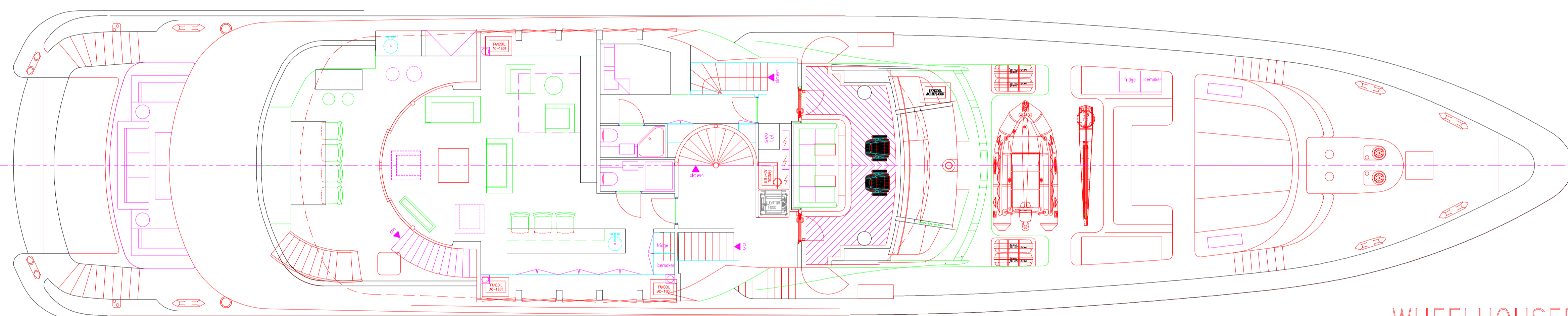

WHEELHOUSEDECK

0 1 2 3 4 5 6 7 8 9 10 11 12 13 14 15 16 17 18 19 20 21 22 23 24 25 26 27 28 29 30 31 32 33 34 35 36 37

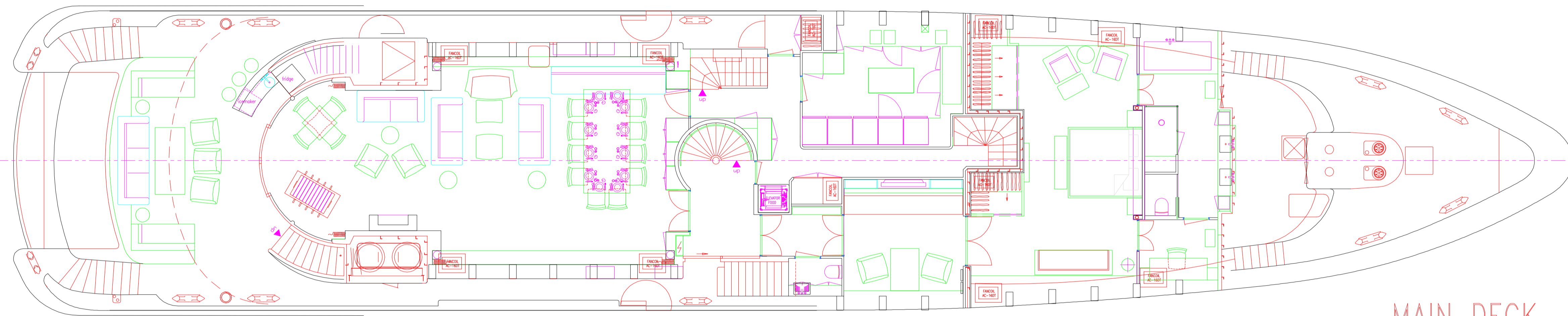

MAIN DECK

0 1 2 3 4 5 6 7 8 9 10 11 12 13 14 15 16 17 18 19 20 21 22 23 24 25 26 27 28 29 30 31 32 33 34 35 36

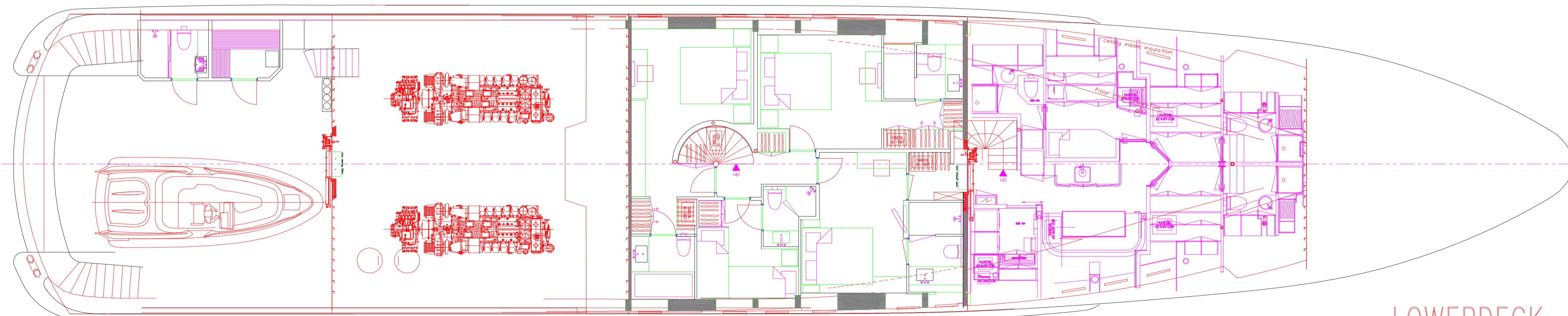

LOWERDECK

0 1 2 3 4 5 6 7 8 9 10 11 12 13 14 15 16 17 18 19 20 21 22 23 24 25 26 27 28 29 30 31 32 33 34 35 36 37

HEESEN
YACHTS



P.O. Box 8 5340 AA Oss
Rijnstraat 2 5347 KL Oss
The Netherlands
Tel +31 (0)412 66 55 44
Fax +31 (0)412 66 55 66
E-mail info@heesen-yachts.nl

YARD NO. 13844 TITLE General Arrangement Plan

DRAWN	GJH / FL	DATE	2005-10-26	DRW. NO.	138-gap
CHECKED	Omega	DATE	2005-10-26	ACT. NO.	
APPR. D&D		DATE		REVISION	-
APPR. PROD.		DATE		SCALE	1:100